

**4 Off Equal Diameter Holes  
To Be Used For Mounting**

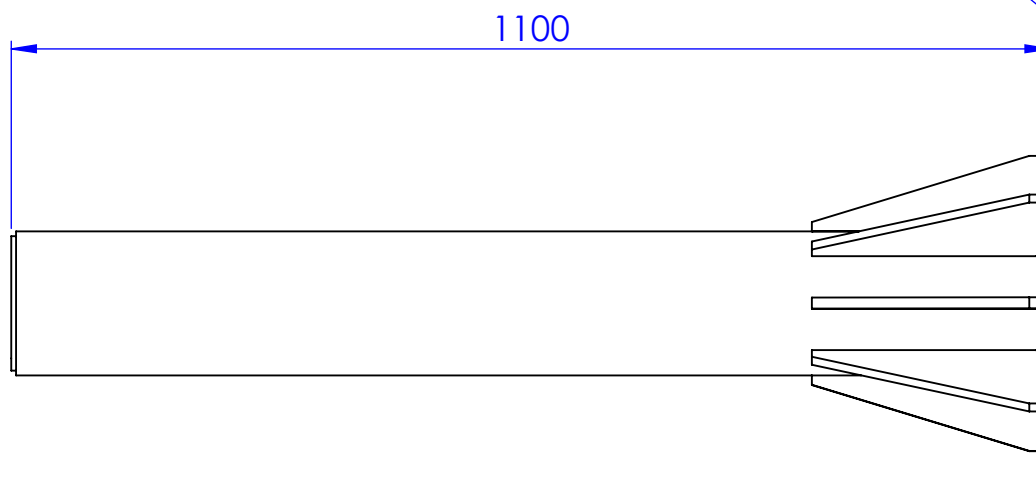

**Ø 18  
Hole Pattern For  
16mm Fasteners**

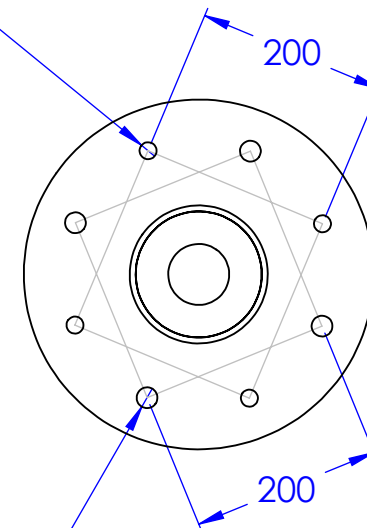

**Ø 22  
Hole Pattern For  
20mm Fasteners  
(Compatible With Existing TMS Fittings)**

DO NOT SCALE DRAWING

REVISION

DRAWN	NAME	DATE	FINISH:
CHK'D	C.MEEK-WELSH	05/01/2015	Natural
APPV'D			MATERIAL: Aluminium
ALL COPYRIGHT AND DESIGN RIGHT SUBSISTING IN THIS DOCUMENT IS THE PROPERTY OF REID LIFTING LIMITED AND MAY NOT BE REPRODUCED WITHOUT REID LIFTING'S CONSENT. THIS DOCUMENT AND THE INFORMATION CONTAINED WITHIN IT IS CONFIDENTIAL AND MAY NOT BE DISCLOSED TO ANY THIRD PARTY NOR USED FOR ANY UNAUTHORISED PURPOSE WITHOUT REID LIFTING'S CONSENT			
UNLESS OTHERWISE SPECIFIED: DIMENSIONS ARE IN MILLIMETERS GENERAL MACHINING TOLERANCES $\pm 0.10$ mm GENERAL FABRICATION TOLERANCES $\pm 1.00$ mm DEBUR AND BREAK SHARP EDGES			

TITLE: **1100mm Pedestal Socket**

DWG NO. **SP0500 - 1100** A4

Weight: SCALE: 1:8 SHEET 1 OF 1